



Vonix Limited
www.vonix.co.uk

Push Button Regulators

For Gas Cylinders



PRODUCT CODE SERIES 300

vonix



PUSH BUTTON REGULATOR C10 BRASS NP

Product Code: 301

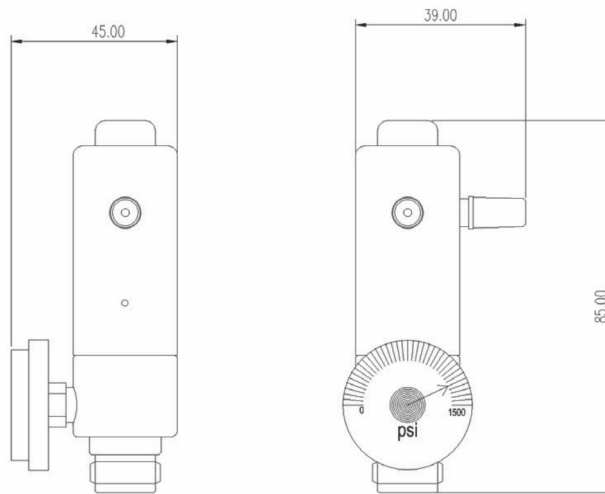

The Push Button Regulator allows the end user to manually draw gas at a constant flow, at a specific time from the cylinder with negligible flow loss. They are used for bump testing of hand-held gas detectors.

Materials of construction

| | |
|-----------------|--|
| Body | Brass Nickel Plated |
| CAP | Brass Nickel Plated |
| Piston | Brass |
| Button | Brass Nickel Plated |
| Seats and Seals | Viton, Buna-N, Teflon |
| Flow | Fixed as per customers requirement - 0.1 to 8.0 L/Mn |

| Model | Maximum Inlet Pressure | For Reactive gases and/or non-reactive gases | Inlet Connection | Outlet Connection | Outlet Pressure | Gauge | Weight Kg |
|-------|-------------------------|--|------------------|-------------------|-----------------|------------------------------|-----------|
| 301 | 0 to 1200 Psig / 83 bar | Brass NP- For Non-Reactive Gases | 5/8"x18UN C10 | 6 MM Taper | 60 psig- 4.1bar | Brass 0 to 1500 psig 103 bar | 0.330 Kg |

Warranty:- All regulators are warranted for 12 months.

VONIX

Vonix Limited

E: info@vonix.co.uk
W: www.vonix.co.uk



PUSH TYPE REGULATOR C10 BRASS NP

Product Code: 302

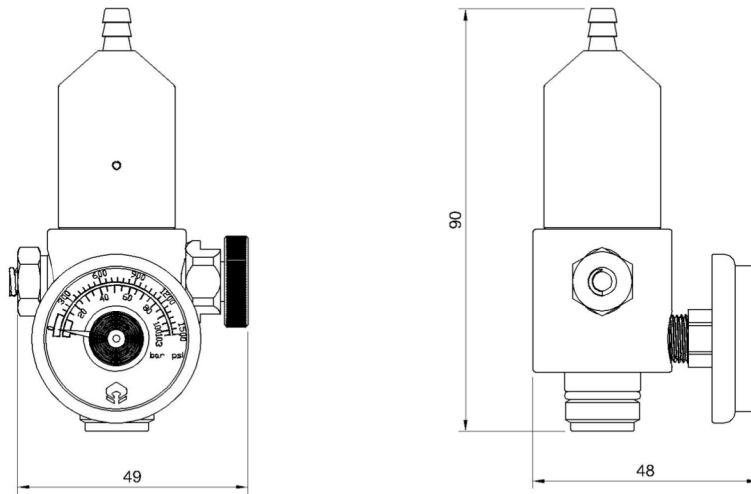

The Push Type Regulator allows the end user to manually draw gas at a constant flow, at a specific time from the cylinder with negligible flow loss. They are used for bump testing of hand- held gas detectors.

Materials of construction

| | |
|-----------------|--|
| Body | Stainless Steel |
| CAP | Brass Nickel Plated |
| Piston | Brass |
| Button | Brass Nickel Plated |
| Seats and Seals | Viton, HNT |
| Flow | Fixed as per customers requirement - 0.1 to 8.0 L/Mn |

| Model | Maximum Inlet Pressure | For Reactive gases and/or non-reactive gases | Inlet Connection | Outlet Connection | Outlet Pressure | Gauge | Weight Kg |
|-------|-------------------------|--|--------------------|-------------------|-----------------|-----------------------------------|-----------|
| 302 | 0 to 1200 Psig / 83 bar | Brass NP- For Non-Reactive Gases | 5/8" X 18 UN - C10 | 3/16" Barb | 60 psig- 4.1bar | Brass N.P. 0 to 1500 psig 103 bar | 0.326 Kg |

Warranty:- All regulators are warranted for 12 months.



PUSH TYPE REGULATOR C10-SS

Product Code: 303

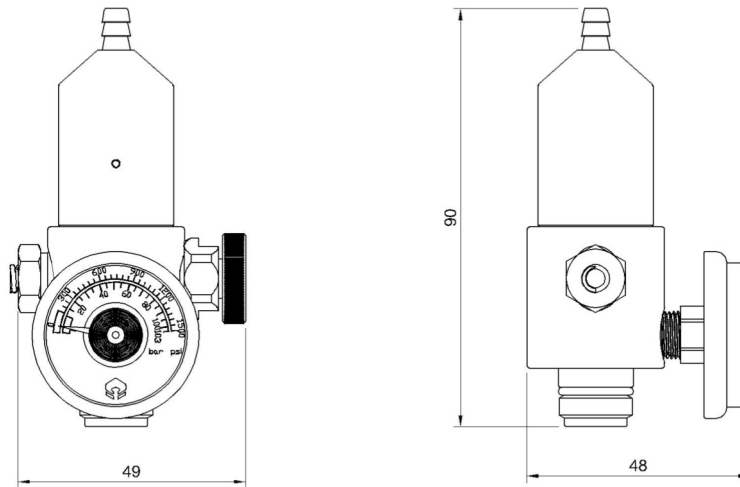

The Push Type Regulator allows the end user to manually draw gas at a constant flow, at a specific time from the cylinder with negligible flow loss. They are used for bump testing of hand- held gas detectors.

Materials of construction

| | | | |
|-----------------|--|--|--|
| Body | Stainless Steel | | |
| CAP | Stainless Steel | | |
| Piston | Stainless Steel | | |
| Button | Brass Nickel Plated | | |
| Seats and Seals | Viton | | |
| Flow | Fixed as per customers requirement - 0.1 to 8.0 L/Mn | | |

| Model | Maximum Inlet Pressure | For Reactive gases and/or non-reactive gases | Inlet Connection | Outlet Connection | Outlet Pressure | Gauge | Weight Kg |
|-------|-------------------------|--|------------------|-------------------|-----------------|--|-----------|
| 303 | 0 to 1200 Psig / 83 bar | Stainless Steel For Reactive Gases | 5/8"x18UN C10 | 3/16" Barb | 60 psig- 4.1bar | Stainless Steel 0 to 1500 psig 103 bar | 0.326 Kg |

Warranty:- All regulators are warranted for 12 months.

vonix

Vonix Limited

E: info@vonix.co.uk
W: www.vonix.co.uk



Vonix Limited
info@vonix.co.uk

www.vonix.co.uk